

**BEFORE THE NATIONAL GREEN TRIBUNAL
SOUTHERN ZONE, CHENNAI (SZ)
ORIGINAL APPLICATION NO.17 OF 2022**

IN THE MATTER OF:

Permandlla Kiran Kumar
Medchal Malkajgiri District
Hyderabad.

...Applicant(s)

-vs-

The State of Telangana Rep.
by its Secretary Public Hyderabad
and Ors.

..Respondent(s)

REPORT FILED BY THE DISTRICT COLLECTOR R-4

S.NO	INDEX	PG-NO
1.	REPORT FILED BY THE 4 TH RESPONDENT	1-6
2.	ANNEXURE-I SURVEY DEPARTMENT REPORT SENT TO DISTRICT COLLECTOR	7-11
3.	ANNEXURE-II MAP SHOWING GAJULARAMARAM FOREST BLOCK	12-13

Place: Chennai
Date: 20.03.2025

Mrs. H. Yasmeen Ali,

Standing counsel for 4TH Respondent

1

REPORT OF THE DISTRICT COLLECTOR, MEDCHAL MALKAJGIRI DISTRICT
(R4) DATED: -12-2024 IN ORIGINAL APPLICATION NO.17 OF 2022 (SZ) FILED
BY SRI PERMANDLA KIRAN KUMAR, HYDERABAD
&&&&&

It is kindly submitted that Sri Permandla Kiran Kumar, Hyderabad has sent a representation to the Chairman, Hon'ble NGT, Southern Zone Bench, Chennai regarding encroachment in to the Water bodies and the Forest land by the real estate developers.

In this regard it is submitted that, in compliance to the orders issued to conduct the revised joint survey to ascertain the overlapping of the Forest land with Sy.No.19 of Gajularamaram Village Quthbullapur Mandal Medchal Malkajgiri District, the joint survey was conducted on 20.11.2024 by the team constituted by the Commissioner & Director of Survey & Land Records duly after issuing notice to all the concerned.

Accordingly, the finding / report are as follows :

- 1) In Maratwada system of survey method of field survey was chain and cross staff. During initial survey no traverse survey was carried out. Traverse survey was carried out after some time for villages falling inside and around Hyderabad. For this particular village also survey was conducted, sethwar and village map were prepared in 1957 and traverse survey was carried out in the year 1956 but traverse records were not brought into the village map.
- 2) A system of laying long base lines called Adhar, katkoon, karan was the main control for creation of village survey records. These lines were passing mostly through patta lands. Government land were not physically surveyed but their shape was obtained by plotting tippons (measurements) of adjacent patta lands. This resulted in creation of village maps with intrinsic errors.
- 3) A village map is meant for showing location of a survey number and its adjacency with other survey numbers. It is not meant for demarcation at all. As per circular no. Rc.No.F1/4421/65,29.09.1966 Tippon shall be used for demarcation of any survey number.
- 4) To demarcate any gut number (scale number) the adjacent patta survey numbers shall be demarcated with their tippons. The patta number boundary shall be the common boundary between the gut number and patta number.
- 5) As such the boundary of Sy.No.28 is fixed as per the tippon of that survey number which is the valid boundary between Sy.No.28 (patta) and adjacent gut survey number 19.

The measurement of 800m in village map is an intrinsic error crept in while preparing the village map of Gajularamaram in 1957 which can be got clarified by comparing the distance in between NW tri-junction point and bi-junction point between Sy.No.28 and Sy.No.29.

After carrying out DGPS survey of the points on village boundary and the points of Sy.No.19 of Gajularamaram it is observed that the demarcation of Sy.No.28 basing on its tippon is found correct.

As per the above observations, the District Collector has requested to furnish remarks of District Forest Officer on the finding of said survey report. Accordingly, the following Para-wise remarks submitted on the Joint inspection report as follows :

Para-1 & 2 are only narration method of survey to be done/done by the S&LR Departmental authorities while preparing the Village map. However, as stated by the concerned authorities, the survey of the areas of Patta Lands as well Government Lands have already been demarcated and fixed the boundaries in Gajularamaram Village long back in the year 1956 & 1957.

In reply to the contents of Para-3 of the joint inspection report in question, it was submitted that as stated by the concerned authorities in Para-1 of the Inspection Report, the survey of the areas of Patta Lands as well Government Lands have already been demarcated and fixed the boundaries by survey department in Gajularamaram Village long back in the year 1956 & 1957. However, as argued by the Forest department, there are permanent Boundary Stones already existing at Try-Junction & By- Junction Points of Sy. No. 19 of Gajularamaram Village which are intact permanently even as on this date which can be taken into the consideration as Tippons to be used for demarcation of any survey numbers in general and more particularly, the Sy. No. 19 of Gajularamaram Village which the entire area of Ac. 471-14 guntas has already been declared as Gajularamaram RF Block which was notified under Section 29 of Hyderabad Forest Act, 1355 Fasli.

3. Para-4:

In reply to the contents of Para-4 of the joint inspection Report, it was submitted that as already stated in reply to Para-3 above, there are permanent Boundary Stones already existing at Try-Junction & By- Junction Points of Sy. No. 19 of Gajularamaram Village which are intact permanently even as on this date which should be taken into the consideration as Tippons to be used for demarcation of any survey numbers in general and more particularly Sy. No. 19 of Gajularamaram Village. But, unfortunately the said joint Survey Team did not started the resurvey taking into the consideration of the said Try & By Junction points to decide the status of the subject land in Sy. No. 19 of Gajularamaram Village. However, as per the joint survey of Sy. No. 19 situated in Gajularamaram Forest Block done by the Regional Deputy Director, Survey & Land Records, Hyderabad as reported in Rc.No.A5= 156-2021; Dt: 18.03.2023 (Copy and map enclosed), the total area of Sy. No. 19 of Gajularamaram Village is Ac. 471-14 guntas as per the Pahani (1958-59), while the area as per Village map (1957 AD) is Ac. 437-00 guntas, but as per physical possession, there is only Ac. 442-00 guntas of land belongs to Sy. 19 by the Forest Department. However, in subsequent survey conducted and as per report of the Commissioner and Director of Settlements, Survey & Land Records, Telangana State, Hyderabad in Rc.No.F1/1492/2021; Dt: 23.08.2024 (Copy and map enclosed), they contended that the said area in possession is only Ac. 430-00 Gts. Thus, still there is shortage of notified Forestland to an extent of Ac. 41.14 gts as on the date, which clearly indicates that the said shortfall of notified Forestland is under illegal occupation of private persons. Further, the S&LR authorities have also declared that private persons are in encroachment in Sy. 19 belonging to Forest Department, which is worked out to be Ac. 16-21 guntas, while others' land (except Sy. No. 19) to the extent of Ac. 35-03 guntas is in occupation of Forest Department in the field. But, this version of the S & LR Departmental official was not accepted by the Forest Department as despite of repeated requests made by forest Department, the RDD, S&LR, Hyderabad and his team has not taken up the survey commencing from Try-junction and By-junctions which is ought to be done and the Forest Department accordingly reported the same facts to the Hon'ble NGT., SZ., Chennai in counter affidavit filed by Forest Department. Since, there are discrepancies in the survey reports submitted by the ADCLR, the Regional Deputy Director, Survey, Settlements & Land Records, Telangana State Hyderabad, it was requested to conduct joint survey once again afresh starting the survey from Tri-Junction Point/Station No. 1 so as to enable to arrive the final conclusion. But, as the S&LR Departmental authorities have not reacted to the occasion, the Hon'ble NGT., SZ., Chennai in its order dated: 22-07- 2024 issued orders directing the RDD, S&LR Department to expedite the process starting from Try-Junction, provide the appropriate Geo coordinates and fix the survey points to enable the respective departments to find out the encroachments and take appropriate action.

In reply to the contents of Para-5 of the joint Inspection Report, it was submitted that the Survey Team constituted by the S&LR Department has done only joint inspection of the site on 20-11-2024 without conducting any survey physically in the land belongs to Sy. No. 19 of Gajularamaram Village included in Gajularamaram Forest Block and drawn up only the inspection note which does not serve the very purpose to exactly identify the area of the Forest Block in the possession of Forest Department and in the possession of the encroachers and this also does not full fill the compliance of the Hon'ble NGT orders. It is also further submit that had, they did survey physically in the field afresh taking the Try-Junction Point as Station-1 as ordered, they would have furnished the surveyed map/sketches to their inspection report which is on hand. It is further submitted that regarding the contents to the extent of 800 Mts., (As stated by Forest Department as 900 Mts., length and 146 Mts., width), the area in question which is totally grown up, covered with full forest species and which is totally in the physical possession, continuous protection and management of the Forest Department, the S&LR authorities are simply saying that it is an intrinsic error crept while preparing the Village map is not acceptable as the entire area starting from Try-Junction point is physically existing in the field in tack which is absolutely belongs to Sy. No. 19 of Gajularamaram and is part of notified Forest Block. Thus, the S&LR Departmental authorities cannot ignore this subjected land resulting shortfall in the notified Forestland. If this land is confirmed to be the Reserve forest, the deviation of shortage in the Reserve forest land will be settled, thereby the greater extent of dispute can be resolved permanently. Otherwise, it amounts provisions of Van (Sanrakshan Evam Samvardhan) Adhinyam, 1980 / Van (Sanrakshan Evam Samvardhan) Rules, 2023 (Forest Conservation Act, 1980).

In reply to the contents of Para-6 of the joint Inspection Report, it was submitted that the issue relates to resolve the dispute of shortage of land in Sy. No. 19 of Gajularamram Village, which is, totally notified Reserve forest land. Whereas, the S&LR Departmental authorities are discussing about the demarcation of Sy. No. 28 basing on its tippons is not correct which is nothing to do with the present issue in question for demarcation of notified Gajularamaram RF Block boundaries.

In view of the above reasons the DFO stated that , the survey now conducted is not agreed to by the Forest Department. Therefore, it is requested to arrange to conduct revised joint survey of the subject land afresh by the Joint Director Survey Department as per the following points to settle the Reserve forest Boundary dispute to avoid legal complications.

I. To commence joint survey of entire notified Reserve forest area of Sy. 19 of Gajularamaram Village starting from Tri-junction where permanent Boundary Stones exist, which are in tack permanently even as on this date.

II. To provide the appropriate Geo-coordinates, demarcate R.f boundary and fix the survey points on the ground.

III. The shape of the Surveyed map should tally as per notified Forest Block map (Block map enclosed)

IV. To provide Map showing existing Reserve Forest Boundary, area surveyed by the Joint Director and legal status of the area excluded with extent with full of forest growth under the control and protection of Forest Department.

In view of the above findings the District Collector, Medchal-Malkajgiri has conveyed a meeting with the officials of DFO and AD Survey and land records and directed the DFO to submit factual report for which the District Forest Officer has requested the Prl.Chief Conservator of Forests & HoFF, Telangana to arrange to depute the Survey team from G.I.S wing to survey entire Sy No.19 of Gajularamaram Village included in Gajularamaram Forest Block to settle the Forest boundary dispute.

A

Accordingly, a letter has been addressed to the Hon'ble NGT with a request to grant eight weeks time period to furnish the required information.

Further, it was submitted that the District Forest Officer, Medchal Division along with Survey team conducted Survey in Sy No.19 of Gajularamaram Village stating that with his Team of staff has taken up the survey of the entire Gajularamaram R.F Block situated in Sy. 19 of Gajularamaram Village with DGPS on 04.02.2025 and 05.02.2025. The survey was started from Tri-junction Station No. 1 to Station Point No. 75 closing at By-Junction and drawn the map. The following is the out-come result of the survey done :

- (i) The survey continued from Tri-junction Station No. 1 to 2 drawing the boundary line between Gajularamaram, Bowrampet and Suraram Reserve forest Blocks. This line remained intact with the Pakka boundary pillars erected. However, there is a land dispute to the extent of Ac. 02-09 Gts., for which W.P. No. 11082 of 2021 & 13319 of 2021 are filed in which Counter Affidavits have already been filed and the cases are pending with Hon'ble High Court for the State of Telangana at Hyderabad.
- a. Distance from Station No.1 to 2 is 824 M as per village map and as per forest block notification.
- b. As per physical possession of Forest Department, the distance from Station No. 1 to 2 is showing as 788 M for which map is prepared.
- c. As per Regional Dy. Director, Survey & Land Records survey rep Dt: 18.03.2024 and 23.08.2024, the distance from Station No 1 to 2 shown as 678 M.
- (ii) The survey continued from Station No. 2 to 3 drawing the boundary line between Gajularamaram RF Block and Sy.No.28 as per physical possession, but not as per notified Forest boundary and Village map for which, the boundary line remained intact with old Pakka (permanent) boundary pillars erected at respective stations.
- (iii) The survey continued from Station No. 3 to 7 drawing the boundary line between Gajularamaram RF Block and Sy. Nos.23,21,20 having been constructed compound wall with Coarsed Rubble Stone (CRS masonry) and remained intact with old Pakka (permanent) boundary pillars erected at respective stations.
- (iv) The survey continued from Station No. 7 to 9 drawing the boundary line between Gajularamaram RF Block and Sy.Nos 20. This line remains intact with old Pakka boundary pillars.
- (v) The survey continued from Station No. 9 to 12 drawing the boundary line between Gajularamaram RF Block and Sy.Nos.20,32,68,69,70. This line remained intact with the Pakka boundary pillars erected with chain link fencing.
- (vi) The survey continued from Station No. 12 and runs up to station Nos 13,14,15,16,17,18,19,20,21,22 and 23 and Sy.Nos.70,89,92,93,98 and 18. However some encroachers have occupied certain area and raising Agricultural crops and habitation, the above survey stations are fixed by the RDD., S&LR., Hyderabad after conducting survey. This land required has to be retrieved by getting the encroachers evicted.
- (vii) The survey continued from Station No. 23 to 25 drawing the boundary line between Gajularamaram RF Block and Sy.Nos. 16 and 15. This line remained intact with the Pakka boundary old existing pillars erected. However, there is a land dispute to an extent of Ac. 01-05 Gts., for which W.P. No. 21412 of 2022 filed in which Counter Affidavit has already been filed and the case is pending with Hon'ble High Court for the State of Telangana, at Hyderabad.
- (viii) The survey continued from Station No. 25 to 30 drawing the boundary line between Gajularamaram RF Block and Sy.Nos. 12 and 15. This line remained intact with

The Pakka old boundary pillars erected with chain link fencing from Station No. 26 to 30. As per Regional Dy. Director, Survey & Land Records survey, part of habitation is falling inside the R.F boundary for which notices have been issued to the encroachers by the GHMC officials. Further, part of equal Forest area is falling outside the R.F boundary.

(ix) The survey continued from Station No. 30 to 32 drawing the boundary line between Gajulramaram RF Block and Sy. Nos. 445. This line remained intact duly having constructed the boundary with Stone masonry up to basement. However, there is a land dispute to an extent of Ac. 01-08 Gts., and Ac. 02-00 Gts., for which W.P. No. 21398 of 2022 and W.P. No. 4741 of 2022 filed in which, Counter Affidavits have already been filed and the cases are pending with Hon'ble High Court for the State of Telangana at Hyderabad.

(x) The survey continued from Station No. 32 to 43 drawing the boundary line between Gajulramaram RF Block and Sy. Nos. 444, 440, 439, 438, 435, 420, 419 and 398. This line remained intact with the Pakka old boundary pillars erected and fixed Chain link fencing which is confirmed in the survey conducted earlier by the RDD., S&LR., Hyderabad. From Station Nos. 33 to 43 some open land outside existing boundary line is shown as included in the RF area, as per survey conducted by the Regional Dy. Director, Survey & Land Records.

(xi) The survey continued from Station No. 43 to 62 drawing the boundary line between Gajulramaram RF Block and Sy. Nos. 397 and 396. However, some have encroached upon the forest land which is confirmed in the survey conducted by the RDD., S&LR., Hyderabad. This land requires to be retrieved by getting the encroachers evicted. However, as the GHMC., Hyderabad is also one of the Respondents in this O.A.No.17 of 2022 in Hon'ble NGT, South zone at Chennai, they have identified the encroachers and already issued notices to evict the forest land. Further follow up action is awaited from the GHMC., Hyderabad. Chain link fencing was done as per present possession to avoid further encroachments.

(xii) The survey continued from Station No. 62 to 69 drawing the boundary line between Gajulramaram RF Block and Sy. Nos. 394, 396 and 380. Some have encroached some of the forest land which is an open land. The same is confirmed in the survey conducted by the RDD., S &LR., Hyderabad. This land requires to be retrieved by getting the encroachers evicted.

(xiii) The survey continued from Station No. 69 to 72 drawing the boundary line between Gajulramaram RF Block and Sy. Nos. 379 and 376. The boundary line remained intact having fixed with chain link fencing as per old existing boundary pillars.

(xiv) The survey continued from Station No. 72 to 74 drawing the boundary line between Gajulramaram RF Block and Sy. Nos. 376, 375 and 373. Some have encroached some of the forest land inside the Reserve forest boundary which is an open land and the same is confirmed in the survey conducted by the RDD., S&LR., Hyderabad. This land requires to be retrieved by getting the encroachers evicted.

(xv) The survey continued from Station No. 74 to 75 drawing the boundary line between Gajulramaram RF Block and Sy. Nos. 373, 372 and 371. The boundary line remains intact having fixed with chain link fencing reaching the By-junction of Bowrampet and Gajularamaram villages reaching Station No. 75.

(xvi) The survey continued from Station No. 75 to 1. The boundary line is remained intact having common boundary between Bowrampet Reserve Forest and Village and Gajularamaram Reserve Forest and Village reaching Station No. 1.

4. In this regard, it is submitted that as per the above DGPS survey done, the area in the custody of the Forest Department and under encroachments is as follows:

Sl.No	Village	Sy.No.	Area included in the Forest Block	
			Hectares	Acres-Gts
1	Gajularamaram	19	190.68	471-14
2	Gajularamaram	25 & 26	5.93	14-26
			196.61	486.00
3	Area now in the custody of F.D. including area in which disputes cases filed in High C	19, 25 & 26	181.30	447-04
	Land encroached by others as confirmed S&LR officials to be retrieved		8.11	20.02
	Total area		189.05	467.06

5. The balance area to an extent of Ac 18-34 Gts., (486.00-467.06) is shortfall.

This is for kind information.

Yours faithfully,

Gowdy

District Collector

Medchal-Malkajgiri District

6-21

GOVERNMENT OF TELANGANA

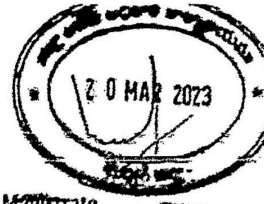

From:
Sri G.V. Maheshwar Rao, B.Tech.,
Regional Deputy Director,
Survey & Land Records,
Hyderabad.

To:
The Collector & District Magistrate,
Medchal-Malkajgiri District.

Sir,

Re: No. 65-156-2021, Dated: 18.03.2023.

Sub: S&LR Dept. - Medchal-Malkajgiri District - Hon'ble NGT, Chennai OA No.17 of 2022 filed by premandlla Kiran Kumar, Gajularamaram (V) Shapurinagar, Jeedimetla, Quthubullapur (M) - Order dated: 11.02.2022 - discrepancy noticed - proposals submitted to conduct joint survey by RDD, S&LR, Hyderabad & DFO Medchal-Malkajgiri - joint inspection conducted - report submitted - Regarding.

- Ref:**
1. Rc.No.LP/631/2022, dated: 06.12.2022 of the Collector & District Magistrate, Medchal-Malkajgiri District.
 2. Rc.No.32/2022/D; Dt: 28.12.2022 of the District Forest Officer, Medchal Malkajgiri District.
 3. This office even letter dated: 21.01.2023 & 20.02.2023.
 4. Notice Rc.No.A2/356/2020, dated: & 23.12.2023, AD/IOS, S&LR Medchal Malkajgiri District.

& &

I invite kind attention to the subject above cited and submit as per proposals submitted vide reference 1st cited to conduct joint survey along with District Forest Officer Medchal Malkajgiri to finalize the total area of Forest land and the area of the encroachment that took place in Sy.No.19 of Gajularamaram village. It is to submit accordingly this office while fixing the date of survey on 27.01.2023 & 28.01.2023 directed the Inspector of Survey, (S&LR) Medchal Malkajgiri District vide reference 3rd cited to issue notices. Wherein the notices for survey were issued vide reference 4th cited.

It is to submit that as per scheduled the joint survey was conducted wherein by utilizing DGPS machine (electronic survey instrument compactable with computer) data was collected. The ground collected DGPS data was analyzed with reference to the village map and subsequently to relay the data on field by fixing joint inspection date on 02.03.2023, 03.03.2023 survey notices to all the concerned were issued vide reference 4th cited read with reference 3rd cited. Accordingly as per schedule the survey work was carried out on 04.03.2023 also and completed demarcation duly by fixing the boundaries of Sy.No.19 of Gajularamaram village and noting encroachment details in Sy.No.19 and other surrounding survey numbers & vice versa. Accordingly a self explanatory location sketch is enclosed for kind perusal and necessary action.

Yours faithfully

G.V. Maheshwar Rao
Regional Deputy Director
Survey and Land Records
Hyderabad

✓ Copy to the District Forest Officer, Medchal Malkajgiri for information and necessary action.

LOCATION SKETCH OF SY.NO.19 (FOREST LAND) SITUATED AT GAJULARAMARAM (V) QUTHBULLAPUR (M), MEDCHAL - MALKAJGIRI DISTRICT.

FILE-NO:-RC.No. A5/156/2021

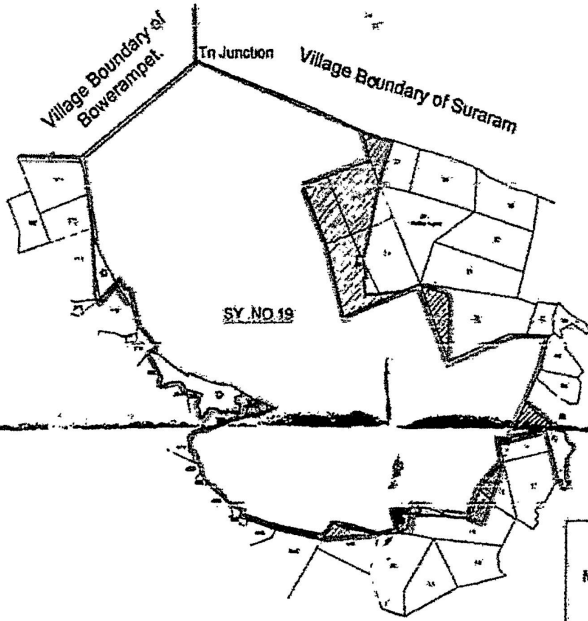

N
A
SCALE : 8"=ONE MILE.

Mark	Forest Possession in other Sy No's except Sy No 19		Mark	Possession of Private Persons in Forest Land in Sy No 19.			
	Sy No	Extent Ac. - Gs		Sy No	Extent Ac. - Gs		
[Hatched Area]	28	2 - 16	[Hatched Area]	Adjacent Sy no's 17, 18, 70, 89 90 & 97	6 - 05		
	20	3 - 00		B	Adjacent Sy.No 16	0 - 37	
	18	0 - 23			C	Adjacent Sy no's 380, 384, 386, 387 & 388	7 - 12
	16	1 - 02		D		Adjacent Sy no's 372 & 373	2 - 07
	15p	1 - 18				Total	16 - 21
	15q	0 - 36					
	445	1 - 16					
	376	0 - 18					
	24 In 27	22 - 27					
	Total	35 - 03					

INDEX

Mark	Sy No	Classifi- cation	Extent as per Pahanu rrose Sy	Extent obtain as per Village Map 1957 AD	As per Physical Possession of Forest in Sy.No.19.
[Square Mark]	19	Garau	Ac - Gs 471 - 14	Ac - Gs 437 - 00	Ac - Gs 442 - 00

1/24/21

[Handwritten signatures and notes]

Regl Dy. Director
S.R.Os Hyderabad.

GOVERNMENT OF TELANGANA

From
Dr. Buddha Prakash Jyoti, I.A.S.,
Commissioner & Director of
Settlements, Survey & Land Records,
Telangana State, Hyderabad.

To
The District Forest Officer,
Medchal-Malkajgiri district.

Lr.No. F1/1492/2021, dated: - 23-08-2024.

Sir,

Sub:- Suits- O.A.No.17 of 2022 (SZ) of NGT Chennai filed by Sri Perumandla Kiran Kumar- Orders passed by Hon'ble NGT Chennai dt: 22-07-2024- Boundary dispute- Gajularamaram Forest Block- Sy.No.19 of Gajularamaram (v), Medchal (M), Medchal-Malkajgiri district- Survey conducted- report submitted- Reg.

- Ref:- 1) O.A.No.17 of 2022 (SZ) of NGT Chennai filed by Sri Perumandla Kiran Kumar.
2) Your office Lr.No. 32/2022/D, dated: 9-8-2023, 12.10.2023, 20.02.2024, 8.8.2024
3) This office Lr.No.F1/1492/2021, dated: 08.08.2024.
4) Survey Report of the Survey officials team of this office dt: 22-08-2024.

& &

I invite your attention to the references cited. A Survey team was drafted vide this office Lr.No.F1/1492/2021, dated: 08.08.2024 with a direction to show the points and collected DGPS data of Sy.No.19 of Gajularamaram village. Accordingly, the Survey team of (03) Survey personnel's along with Forest officials attended the said work as per scheduled dates i.e., 12.08.2024, 13.08.2024 and 14.08.2024, the boundaries earlier fixed by the then Regional Deputy Director those boundary points were relayed on ground and shown to the Forest officials and collected DGPS Co-ordinates with DGPS instrument. The Collected DGPS data of Sy.No.19 of Gajularamaram village along with sketch is enclosed herewith for taking necessary action.

This is for favour of information and for taking necessary action in the matter.

Yours faithfully,

Encl: Survey report along with Sketch.

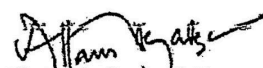
for Commissioner & Director
of Settlements, Survey and Land
Records, TG, Hyderabad.

GPS CO-ORDINATES OF SY.NO.19 (FOREST LAND) OF GAJULARAMAM (V) QUTHBULLAPUR (M), MEDCHAL - MALKAJGIRI DISTRICT. AS PER RDD SURVEY

FILE NO. - RC.No. F/11492/2021

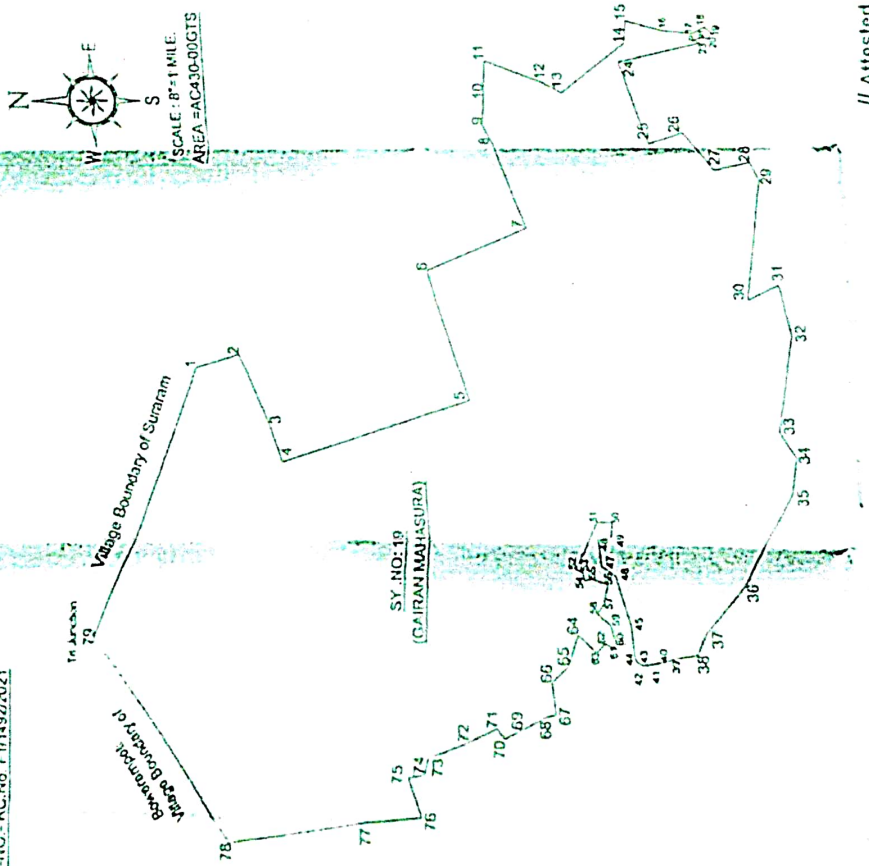

Sl.No	Latitude	Longitude	Sl.No	Latitude	Longitude
1	17.54683	78.41907	41	17.53658	78.41275
2	17.54585	78.41939	42	17.53605	78.41277
3	17.54516	78.4178	43	17.53675	78.41282
4	17.54487	78.41698	44	17.5368	78.41292
5	17.54057	78.41845	45	17.53688	78.41356
6	17.54158	78.42135	46	17.53725	78.41458
7	17.53928	78.42235	47	17.53756	78.41478
8	17.54015	78.42444	48	17.53766	78.41533
9	17.54034	78.42478	49	17.53736	78.4154
10	17.54031	78.42536	50	17.53733	78.41576
11	17.54027	78.42625	51	17.53766	78.41576
12	17.53869	78.42555	52	17.53813	78.41468
13	17.53847	78.42577	53	17.53799	78.41463
14	17.53701	78.4267	54	17.53794	78.41445
15	17.53697	78.42722	55	17.53776	78.41449
16	17.53611	78.42701	56	17.53741	78.41439
17	17.53543	78.42695	57	17.53751	78.41395
18	17.53517	78.42711	58	17.53764	78.41376
19	17.535	78.42698	59	17.53735	78.41355
20	17.53509	78.42683	60	17.53722	78.41332
21	17.5352	78.42587	61	17.53727	78.41309
22	17.5354	78.4268	62	17.53746	78.41316
23	17.53528	78.42673	63	17.53764	78.41297
24	17.53715	78.42677	64	17.53806	78.41332
25	17.53668	78.4244	65	17.53826	78.41269
26	17.53568	78.4247	66	17.53862	78.41232
27	17.53496	78.42381	67	17.53851	78.41168
28	17.534	78.4237	68	17.53877	78.41159
29	17.53394	78.42308	69	17.53926	78.41133
30	17.53421	78.42084	70	17.53967	78.41133
31	17.5335	78.4213	71	17.53982	78.41133
32	17.53322	78.42008	72	17.54048	78.41102
33	17.53355	78.41792	73	17.54134	78.41064
34	17.53318	78.41736	74	17.54145	78.41032
35	17.53328	78.41654	75	17.54182	78.41024
36	17.53437	78.41545	76	17.54147	78.40945
37	17.53523	78.41342	77	17.54273	78.40918
38	17.53541	78.41304	78	17.54576	78.40874
39	17.53595	78.4129	79	17.54901	78.41288
40	17.53608	78.41285			

// Attested //

[Signature]
Deputy Director
M.Z-II

[Signature]
(TSP Surveyor)

[Signature]
MIS
Gazipur

MAP OF BLOCK GAULL RAMARAM

DEMARCATED AREA 494 Acres

SETTLEMENT AREA 477 Acres

EXES AREA 228.0
260

Scale

4 = 1 mile

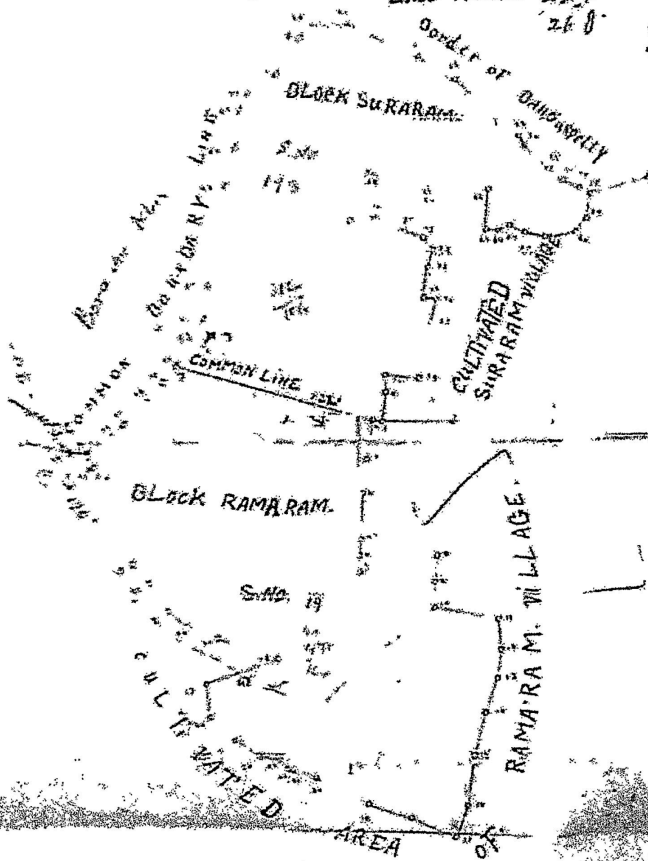

322	18
477	19
265	24

Surveyed by
[Signature]
 Forester Hyderabad

Map Showing Gajularamaram Forest Block
 District: Medchal Malkajigiri, Range: Dulapally, Beat: Suraram



ID	Latitude	Longitude	ID	Latitude	Longitude
1	17.548006	78.412980	39	17.536584	78.412754
2	17.546624	78.419952	40	17.536648	78.412769
3	17.544970	78.419839	41	17.536749	78.412819
4	17.543036	78.419339	42	17.536804	78.412920
5	17.542619	78.419188	43	17.536885	78.413559
6	17.541328	78.419218	44	17.537253	78.414579
7	17.541546	78.421375	45	17.537563	78.414777
8	17.541407	78.422178	46	17.537659	78.415329
9	17.539482	78.423374	47	17.537358	78.415386
10	17.540344	78.424785	48	17.537495	78.415753
11	17.540257	78.426282	49	17.537663	78.415758
12	17.538460	78.425563	50	17.538133	78.414863
13	17.537013	78.426699	51	17.537985	78.414632
14	17.536972	78.427219	52	17.537944	78.414450
15	17.536110	78.427006	53	17.537763	78.414480
16	17.535435	78.426952	54	17.537409	78.414386
17	17.535172	78.427109	55	17.537506	78.413950
18	17.534988	78.426958	56	17.537639	78.413763
19	17.535095	78.426872	57	17.537350	78.413553
20	17.535199	78.426872	58	17.537217	78.413198
21	17.535399	78.426800	59	17.537266	78.413092
22	17.537151	78.426270	60	17.537463	78.413162
23	17.536810	78.424971	61	17.537640	78.412974
24	17.535676	78.424701	62	17.538058	78.413321
25	17.538020	78.423920	63	17.538257	78.412689
26	17.539379	78.423086	64	17.538625	78.412319
27	17.534640	78.421270	65	17.538513	78.411680
28	17.534158	78.421164	66	17.538774	78.411590
29	17.533454	78.421008	67	17.538262	78.411330
30	17.533219	78.420082	68	17.538666	78.411118
31	17.533202	78.418527	69	17.538825	78.411332
32	17.533177	78.417372	70	17.540477	78.411016
33	17.533278	78.416540	71	17.541148	78.410432
34	17.534367	78.414448	72	17.541749	78.410063
35	17.535232	78.413422	73	17.541468	78.409446
36	17.535412	78.413008	74	17.542735	78.409284
37	17.535952	78.412900	75	17.545762	78.408743
38	17.536080	78.412854			

Map Showing Gajularamam Forest Block
 District: Medchal Malkajgiri, Range: Dulapally, Beat: Suraram

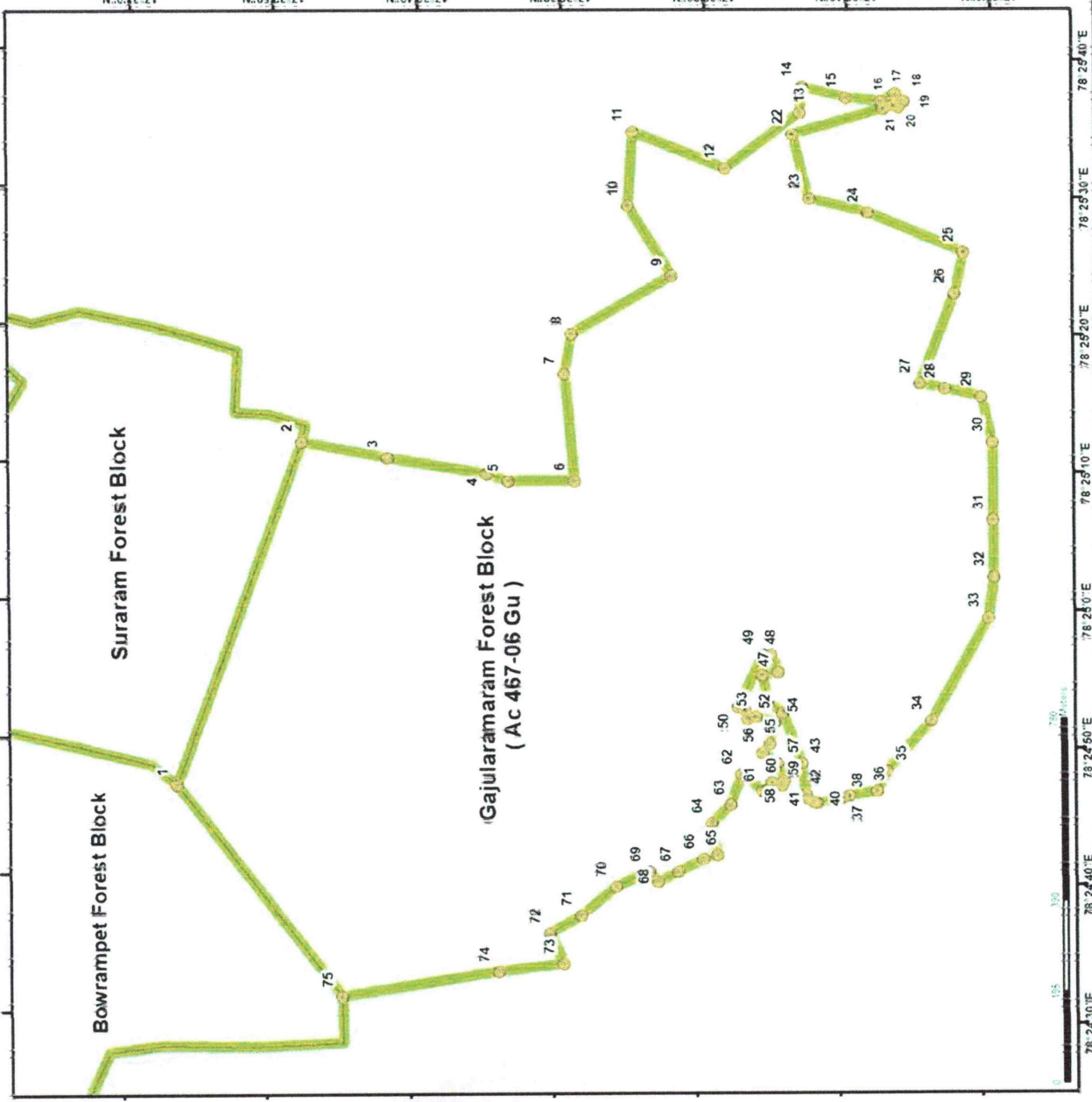

ID	Latitude	Longitude	ID	Latitude	Longitude
1	17.548006	78.412980	39	17.536584	78.412754
2	17.546624	78.419952	40	17.536648	78.412769
3	17.544970	78.419639	41	17.536749	78.412819
4	17.543036	78.419339	42	17.536804	78.412920
5	17.541328	78.419188	43	17.536885	78.413559
6	17.541328	78.419218	44	17.537253	78.414579
7	17.541546	78.421375	45	17.537563	78.414777
8	17.541407	78.422178	46	17.537659	78.415329
9	17.539482	78.423374	47	17.537358	78.415396
10	17.540344	78.424765	48	17.537495	78.415753
11	17.540257	78.426282	49	17.537663	78.415758
12	17.538460	78.425563	50	17.538133	78.414683
13	17.537013	78.426699	51	17.537985	78.414632
14	17.534972	78.427219	52	17.537944	78.414450
15	17.536110	78.427006	53	17.537763	78.414480
16	17.536435	78.426952	54	17.537409	78.414386
17	17.535172	78.427109	55	17.537506	78.413950
18	17.534998	78.426958	56	17.537639	78.413763
19	17.535095	78.426833	57	17.537350	78.413553
20	17.535199	78.426872	58	17.537217	78.413198
21	17.535399	78.426800	59	17.537266	78.413092
22	17.537151	78.426270	60	17.537463	78.413162
23	17.534810	78.424971	61	17.537640	78.412974
24	17.535676	78.424701	62	17.538058	78.413321
25	17.538620	78.423990	63	17.538257	78.412689
26	17.538979	78.423066	64	17.538625	78.412319
27	17.534640	78.421270	65	17.538513	78.411680
28	17.534158	78.421164	66	17.538774	78.411590
29	17.533454	78.421008	67	17.539262	78.411330
30	17.533219	78.420082	68	17.539666	78.411118
31	17.533202	78.418937	69	17.538825	78.411332
32	17.533177	78.417372	70	17.540477	78.411016
33	17.533278	78.416540	71	17.541148	78.410432
34	17.534367	78.414448	72	17.541749	78.410063
35	17.535232	78.413422	73	17.541468	78.409416
36	17.535412	78.413008	74	17.542735	78.409284
37	17.535952	78.412900	75	17.545762	78.408743
38	17.536080	78.412854			